

**ZHAOXIN<sup>®</sup>**

# 3.6V无线胶枪

## HTG-366

### 使用说明书

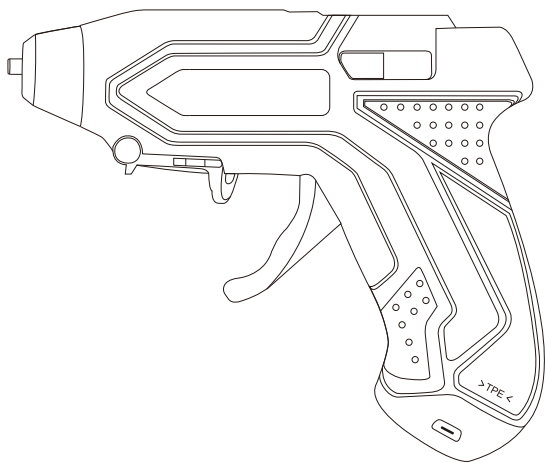

# 技术参数

电池额定电压: 3.6V (直流)

电池(集成电路): 锂离子电池

容量: 2000mAh

加热时间: 60秒

温度: 170°C

胶棒直径: 7mm

充电时间: 3小时

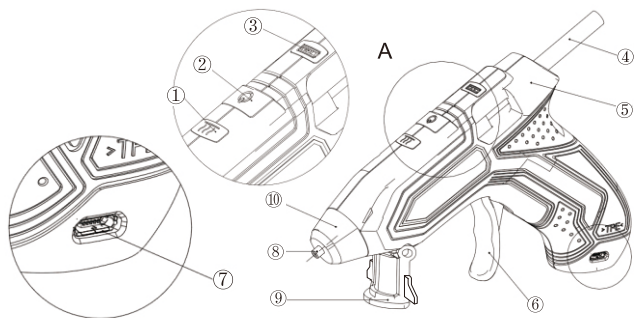

1. 加热指示

3. 电池容量/充电量提示

4. 胶棒

6. 扳机

8. 支架

10. 出胶嘴保护套

2. 开关键

5. 进胶口

7. USB充电器口

9. 出胶嘴

# 包装清单

1. 无线热熔胶枪	.....	1把
2. USB数据线	.....	1条
3. 胶棒	.....	10根
4. 操作说明书	.....	1本
5. 合格证	.....	1张

## WARNING!

● 阅读所有安全警示及使用说明。

● 若未按照说明书操作可能会导致电击, 火灾或严重人身伤害无线电动工具使用方式

1. 因充电器通常是作为一种特别的可充电电池设计的, 用户只能使用制造商提供的充电器充电。否则可能会出现火灾的风险。

2. 只有厂家提供的可充电电池能用于电动工具, 使用其他可充电电池可能造成人身伤害或引起火灾。

3. 不使用时, 需将可充电电池存放在远离别针、硬币、钥匙、钉子、丝或其他会导电的小金属件的地方。可充电电池触点短路可能会引起火灾。

4. 电池滥用将导致可充电电池液体流出。如果出现这种情况: 禁止碰触流出的液体。如果不小心碰到了, 即刻用清水冲洗接触到液体的部位。如果有液体不小心溅到眼睛里, 请及时就医。电池内漏出的液体可能会导致皮肤过敏或烧伤。

## 电池充电器安全指南

8岁或8岁以上儿童, 有身体、感知或心理缺陷或没有经验的人必须在监护下使用此工具, 且在使用之前熟悉使用方法及潜在危险。禁止儿童将其当玩具使用。除非在成人监护之下, 否则不可对此工具进行清洁或其他维护措施。



热熔胶的温度达到105°C左右

## WARNING!

- 禁止用损坏的电源线或电源充电
- 注:损坏的电源线可能引起电击的危险,造成人身伤害。

电池电量显示:

电池电量显示器(3)通过2个颜色的LED灯显示电池充电量

绿色LED灯:

电池已充满电,无线热熔胶枪可以使用了

红色LED灯:

电池未充满电

## 初始操作

嵌入一根胶棒:

- 将胶棒(4)推入进胶口(5)
- 胶枪加热时,直至加热灯变绿即可开始使用

开机:

- 长按开关键(2)约3秒直到加热指示灯(1)变成红色即为开机,然后胶棒开始被加热。
- 产品加热60秒钟后达到可使用的温度,加热指示灯(1)就会变成绿色。

关机:

- 按下开关键(2)直到温度指示灯(1)变暗,胶枪转为关机状态。

# 初始操作

- 在使用后,需小心将喷嘴朝下,直到胶枪冷却再将其收好。  
热的喷嘴(10)可能会造成伤害或火灾。

## 维护清洁:

- 产品必须时刻保持干净,干燥,且不受油或油脂污染
- 禁止液体渗入产品
- 使用一块软布清洁产品
- 禁止使用会损坏塑料件的汽油、溶剂或清洁剂擦拭产品。

## 自动关机:

- 为防止用户忘记关机,无线热熔胶枪在停止使用的10分钟后会自动关机,从而达到省电用途。
- 将胶枪重新开机并检查温度指示灯(1)和电池电量显示(3)确认是否需要再次充电或加热。

# 警告!

- 将产品送给合格专业的维修人员修理,最好不要更换原零部件。这样能确保产品持续安全性
- 电源线只能有厂家或厂家授权的服务代理商更换。这样能确保产品持续安全性
- 该产品只能通过产品本身(电池)提供的能量工作。电池在报废之前取出。当电池被取出,该产品必须切断与电源的连接。电池报废后,应被安全处理。
- 使用过程中严禁拔出胶棒,容易造成枪体堵塞,为达到更好的使用效果,连续使用3-5次建议停5-10秒钟,使胶棒充分加热。

# Hot melt glue gun HTG-366 User manual

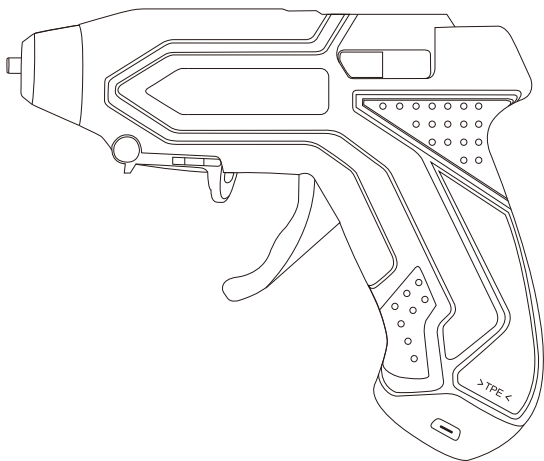

## Technical data

Battery rated voltage: 3.6V= (direct current)

Battery (integrated): LITHIUM-ion

Battery capacity: 2600mAh

Heating time: 90 sec..

Temperature: 170°C

Glue stick diameter: Ø7mm

Charging time: 3 hour

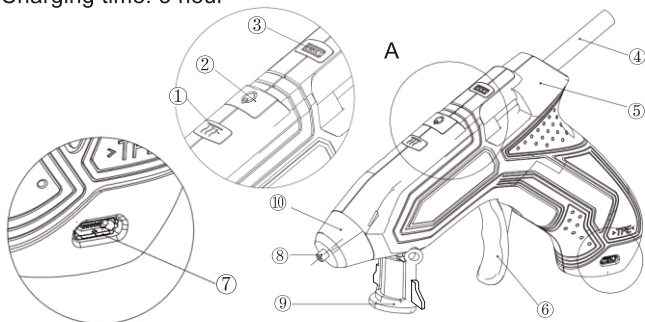

## Annotation

- 1 Temperature indicator
- 2 ON / OFF switch
- 3 Battery capacity / charge level indicator
- 4 Glue stick
- 5 Feeder shaft
- 6 Trigger
- 7 USB power cord
- 8 Nozzle
- 9 Stand bracket
- 10 Thermal protection for nozzle

## **Package contents**

- 1) 1 Cordless hot glue gun
- 2) 1 USB data cable
- 3) 20 glue sticks
- 4) 1 operating instructions

## **WARNING!**

- Read all safety warnings and all instructions.
- Failure to Follow the warnings and safety instructions may result in electric shock, fire and / or serious injury.

## **Use and handling of the cordless power tool**

- a) Charge the appliance using only the charger recommended by the manufacturer. Chargers are often designed for a particular type of rechargeable battery. There is a risk of fire if other types of rechargeable battery are used.
- b) Only the rechargeable battery units supplied are to be used with the power tools. The use of other rechargeable batteries may result in injury or a fire hazard.
- c) When they are not being used, store rechargeable batteries away from paper clips, coins, keys, nails, screws or other small metal objects that could cause the contacts to be bridged. Short-circuiting the contacts of a rechargeable battery may result in burns or fire.
- d) Fluid may leak out of rechargeable batteries if they are misused. If this happens, avoid contact with the fluid. If accidental battery fluid may cause skin irritation or burns.



This appliance may be used by children aged 8 years and above

## **Safety guidelines for battery chargers**

- or lack of experience and knowledge, provided that they are under supervision or have been told how to use the appliance safely and are aware of the potential risks. Children must not use the appliance as a plaything. Cleaning and user maintenance tasks may not be carried out by children unless they are supervised.  
and by persons with limited physical, sensory or mental capabilities



The temperature of adhesive reach a temperature of around 105 °C  
Never operate the charger with a damaged power cord or power  
pf: g. A damaged power cord causes danger to life by electric shock.

## **WARNING!**

### **Battery level display**

The battery level display (3) indicates the charge level using 2 coloured LEDs.

#### **Green LED:**

The battery is fully charged. the cordless hot glue gun is ready for use

#### **Red LED:**

Battery unsaturated

## **Initial operation**

### **Inserting a glue stick:**

- + Push the glue stick (4) into the feeder shaft (5).
- + Allow the appliance heat up for about 90 seconds. The appliance is now ready for use.

### **Switching on:**

- + To turn on the cordless hot glue gun, press the ON / OFF switch (2) until the temperature indicator (1) lights up red. The glue is heated up.
- The temperature indicator (1) lights up green as soon as the appliance has reached working temperature.

### **Switching off:**

- + To turn off the cordless hot glue gun, press the ON / OFF switch (2) until the temperature indicator (1) goes off.
- + After use, place the cordless hot glue gun down carefully and allow it to cool down fully before you store the appliance. The hot nozzle (10) can cause damage and / or burns.

## **Maintenance and cleaning**

- The appliance must always be kept clean, dry and free from oil or grease.
- Never permit fluids to penetrate inside the appliance.
- Use a soft cloth to clean the appliance housing.
- Never use benzine, solvents or cleansers which can damage plastic.

### **Automatic switch off:**

The cordless hot glue gun switches itself off after 10 minutes to save energy.

- ※ Switch the cordless hot glue gun back on and check the temperature indicator (1) and the battery level display (3) to see whether the appliance needs to be recharged or heated further.

## **WARNING!**

Have your appliance repaired by qualified specialists only. Always use original spare parts. This will ensure the ongoing safety of the appliance.

## **WARNING!**

Power cords should only be replaced by the manufacturer of the power tool or the manufacturer's authorized customer service agent. This will ensure the ongoing safety of the appliance.

## **WARNING!**

The appliance is only to be used with the power supply unit provided with the appliance.

- the battery must be removed from the appliance before it is scrapped;
- the appliance must be disconnected from the supply mains when removing the battery;
- the battery is to be disposed of safely.



扫一扫



关注 **ZHAOXIN**® 兆信电子仪器 官方微信

体验更多优惠 更多服务

您也可以搜索官方微信号：兆信电子仪器

**ZHAOXIN**®

## 深圳市兆信电子仪器设备有限公司

地址：深圳市龙岗区龙城街道龙西社区学園路添利工业区3栋四楼

营销中心：深圳市兆信源电子科技有限公司

电话：(86-755)83957113 传真：(86-755)83010865

邮箱：[admin@zhaoxinpower.com](mailto:admin@zhaoxinpower.com)

网站：[www.zhaoxinpower.com](http://www.zhaoxinpower.com)

产品名称：热熔胶枪

产品执行标准：

**Shenzhen Zhaoxin Electronic Instrument Equipment Co., LTD.**

Floor 4, Part Of Floor 3, Bldg. 3, Tianli Ind. Zone, Xueyuan Road, Longxi Community, Longcheng Street, Longgang Dist., Shenzhen, Guangdong, China

Marketing center: Shenzhen Zhaoxinyuan Electronic Technology Co., LTD.

Tel: (86-755)83957113 Fax: (86-755)83010865

Email: [admin@zhaoxinpower.com](mailto:admin@zhaoxinpower.com)

Web: [www.zhaoxinpower.com](http://www.zhaoxinpower.com)



<https://twitter.com/zhaoxinpower>



<https://www.facebook.com/szzhaoxinpower>